

HYDRAUMECH®

Plain Ram, Spring Return Hydraulic Jack (LPS-Series)

Capacity : 10-500 tons Stroke : 50-150 mm Working : 700 bar (Max)

MODEL NO.	Capacity	Closed Ht. 'CH'	Stroke 'S'	Ram Dia 'RD'	Outer Dia 'D'	Oil volume	Approx Weight	Suitable Hand Pump
	tons.	mm.	mm.	mm.	mm.	cc.	kgs.	
LPS-10/50	10	140	50	38	65	88	3	PHP-200/2
LPS-10/100	10	190	100	38	65	164	3.5	PHP-200/2
LPS-10/150	10	240	150	38	65	243	4.9	PHP-200/2
LPS-15/50	15	150	50	45	70	131	3.5	PHP-200/2
LPS-15/100	15	200	100	45	70	247	4.6	PHP-200/2
LPS-15/150	15	250	150	45	70	366	5.2	PHP-200/2
LPS-20/50	20	160	50	50	80	155	4.9	PHP-200/2
LPS-20/100	20	210	100	50	80	324	5.7	PHP-200/2
LPS-20/150	20	260	150	50	80	480	7.1	PHP-200/3
LPS-25/50	25	170	50	60	90	156	6.8	PHP-200/2
LPS-25/100	25	220	100	60	90	404	8.2	PHP-200/3
LPS-25/150	25	270	150	60	90	596	10.2	PHP-200/3
LPS-30/50	30	170	50	65	100	251	8.0	PHP-200/2
LPS-30/100	30	220	100	65	100	528	10.5	PHP-200/3
LPS-30/150	30	270	150	65	100	779	14.5	PHP-200/3
LPS-50/50	50	185	50	80	130	425	17.0	PHP-200/3
LPS-50/100	50	235	100	80	130	817	19.4	PHP-500/6
LPS-50/150	50	285	150	80	130	1209	22.5	PHP-500/6
LPS-75/50	75	200	50	95	155	622	23.0	PHP-500/6
LPS-75/100	75	250	100	95	155	1188	28.5	PHP-500/6
LPS-75/150	75	300	150	95	155	1753	32.5	PHP-500/6
LPS-100/50	100	215	50	120	175	830	36.0	PHP-500/6
LPS-100/100	100	265	100	120	175	1616	40.6	PHP-500/6
LPS-100/150	100	315	150	120	175	2386	47.3	PHP-500/6
LPS-150/100	150	275	100	140	226	2383	65.0	PHP-500/6
LPS-150/150	150	325	150	140	226	3518	75.0	PHP-500/6
LPS-200/100	200	290	100	160	256	3141	88.0	PHP-500/12
LPS-200/150	200	340	150	160	256	4874	100.0	PHP-500/12
LPS-250/100	250	295	100	180	286	3991	115.0	PHP-500/12
LPS-250/150	250	345	150	180	286	5892	131.0	PHP-500/12
LPS-300/100	300	310	100	200	315	4746	148.1	PHP-500/12
LPS-300/150	300	360	150	200	315	7012	167.0	PHP-500/16
LPS-400/100	400	330	100	220	355	6465	200.0	PHP-500/20*PP
LPS-400/150	400	380	150	220	355	9544	225.0	PHP-500/20*PP
LPS-500/100	500	350	100	250	405	7925	281.2	PHP-500/20*PP
LPS-500/150	500	400	150	250	405	11700	315.0	PHP-500/20*PP

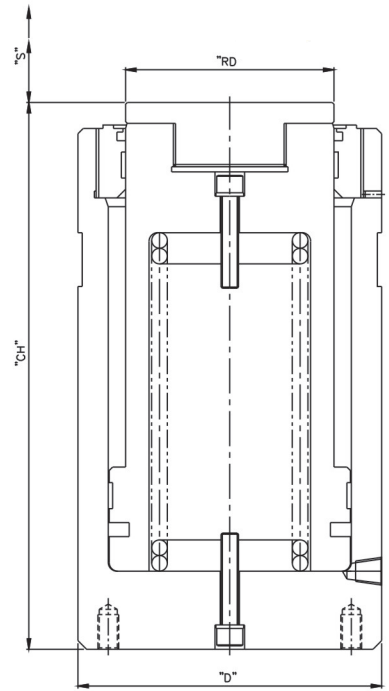

Features / Benefits :

- High strength, Heat treated alloy steel body.
- Hard chrome plated ram to resist scoring and corrosion.
- Single acting spring return for smooth lowering. • High pressure long life seals.
- Wiper to arrest ingress of foreign particles. • Bottom mounting holes for bolting.
- Adequate gripping by grooved saddle. • Port Size 3/8" NPT.
- Customised capacity, strokes, Collar threading and tilting saddle available on request
- QCC with Plastic dust cap. Aluminum dust cap on request.

Application :

These jacks are an excellent choice for maintenance, positioning, bending, pressing, ideal for wide range of applications at construction site, mills, railway workshops, power plants and industrial maintenance.

*PP-Powerpack